

# Technical Information

## 56C Frame — 1-Phase and 3-Phase

NEMA AC TEFC Footed and Round Body Performance Data and Mounting Dimensions

### 1-Phase With or Without Thermal Protection and Manual Reset

HP	RPM	FRAME	PHASE	VOLT	HZ	AMPS 230V	LRT %	BDT %	LRA %	EFF %	PF %	C DIM	LBS
1/3	3450	56C	1	115/230	60	2.4	300	180	700	57	82	10.95	23.2
	1720	56C	1	115/230	60	3	280	180	700	60	59	10.95	23.2
1/2	3450	56C	1	115/230	60	3.1	280	180	700	63	83	10.95	24.3
	1720	56C	1	115/230	60	4	250	180	700	62	65	10.95	24.3
3/4	3450	56C	1	115/230	60	4.5	280	180	700	64	83	10.95	26.5
	1720	56C	1	115/230	60	4.6	250	180	700	73	71	11.42	31
1	3450	56C	1	115/230	60	6.2	250	180	700	64	83	11.42	32
	1720	56C	1	115/230	60	6.1	250	180	700	73	73	11.90	36.4
1.5	3450	56C	1	115/230	60	8.7	250	180	700	66	84	11.90	39.7
	1720	56C	1	115/230	60	8.4	250	180	700	74	77	12.90	40.8
2	3450	56HC	1	115/230	60	10.8	250	180	700	72	84	12.90	43
	1720	56HC	1	115/230	60	9	170	170	600	76	95	12.90	43

### 3-Phase

HP	RPM	FRAME	PHASE	VOLT	HZ	AMPS 460V	LRT %	BDT %	LRA %	EFF %	PF %	C DIM	LBS
1/3	3400	56C	3	230/460	60	0.65	400	420	700	59	83	10.95	21
	1700	56C	3	230/460	60	0.5	280	320	700	79	81	10.95	20.5
1/2	3400	56C	3	230/460	60	0.88	400	400	700	62	85	10.95	22.1
	1700	56C	3	230/460	60	0.9	260	280	700	71	75	10.95	21.2
3/4	3400	56C	3	230/460	60	1.2	380	390	700	69	84	10.95	23.4
	1700	56C	3	230/460	60	1.3	270	320	700	72	76	10.95	22.7
1	3400	56C	3	230/460	60	1.6	380	370	800	69	85	10.95	25.5
	1700	56C	3	230/460	60	1.7	290	320	700	79	73	10.95	23.6
1.5	3400	56C	3	230/460	60	2.3	390	350	700	72	85	10.95	29.5
	1700	56C	3	230/460	60	2.2	280	320	700	83	76	11.50	26
2	3400	56HC	3	230/460	60	2.7	360	360	900	80	88	11.50	35.3
	1700	56HC	3	230/460	60	2.9	280	330	700	82	80	12.40	31.1
3	3400	56HC	3	230/460	60	3.8	340	350	800	80	83	12.40	37.5

NOTE: 230/460V suitable at 208V

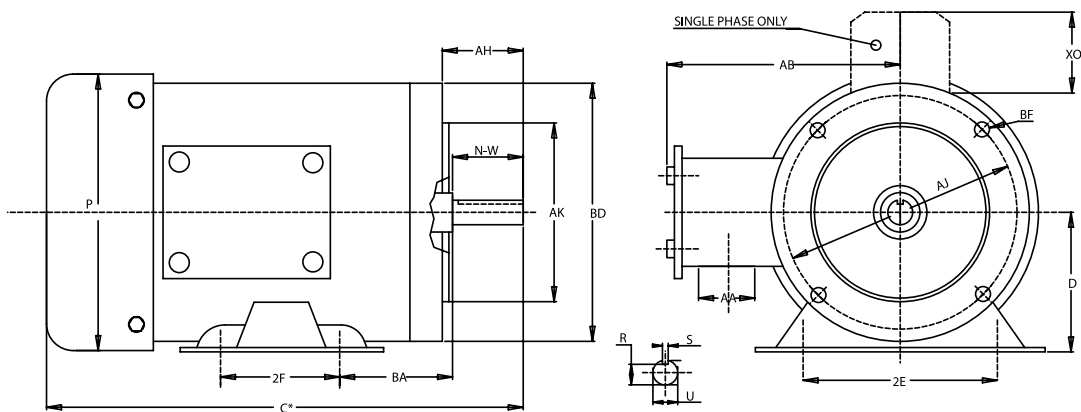

FRAME	PH	D	2E	2F	BA	N-W	R	S	U	AH	AJ	AK	BF	AA	AB	BD	P	X0
56C	1	3.5	4.88	3	2.75	1-7/8	33/64	3/16	5/8	2 1/16	5-7/8	4 1/2	3/8-16	0.87	5 5/16	6 19/32	7 1/10	1.72
56C	3	3.5	4.88	3	2.75	1-7/8	33/64	3/16	5/8	2 1/16	5-7/8	4 1/2	3/8-16	0.87	5 5/16	6 19/32	7 1/10	-

NOTE: C Dimension included in performance data.  
2 HP 1-Phase motor has 2 capacitors.